

Parts for Pump Models: SP1500, SP1510, SP1511, SP1550, SP1575, EP1500 Series; and Pump Strainer SP1516

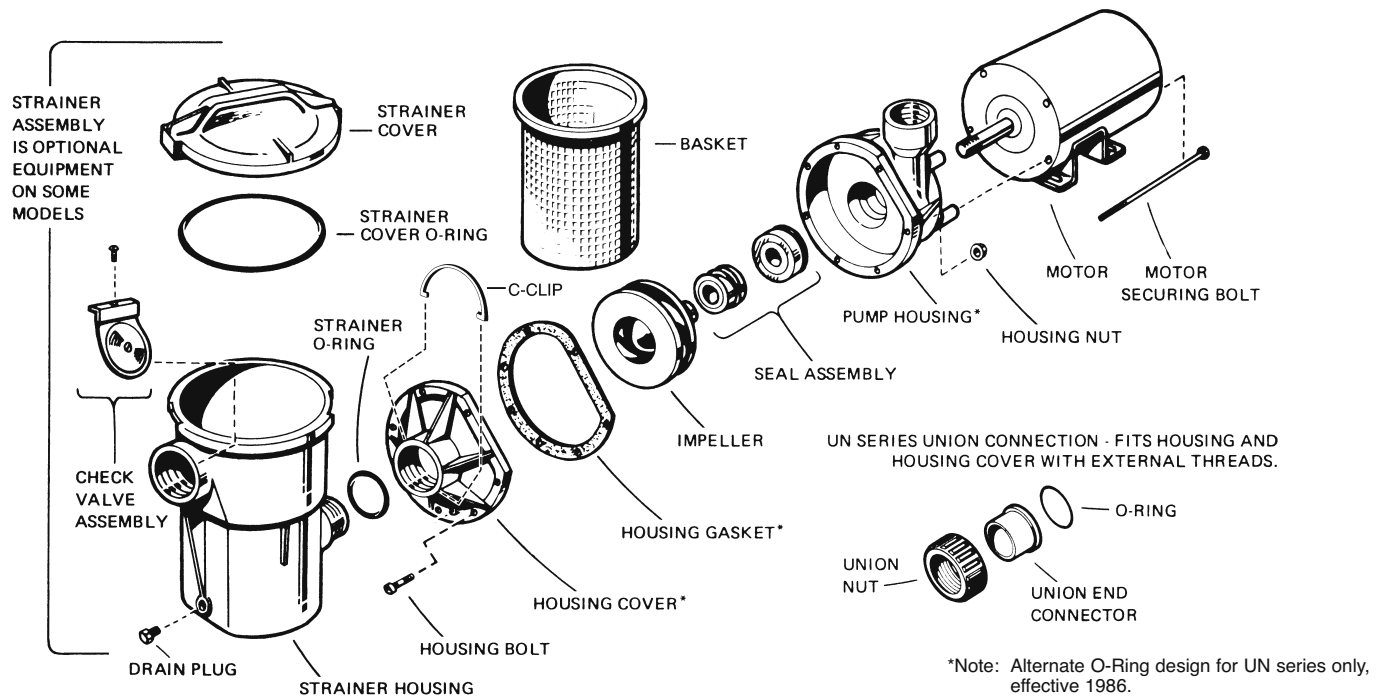

Part No.	Description	Ctn. Qty.
SPX1500AA	Pump Housing	4
SPX1500B	Housing Cover	2
SPX1500KA	Seal Assembly w/Cup	10
SPX1500H	Housing Gasket	10
SPX1500N2	Housing Bolt, No. 10-24 Hex. Head	20
SPX1500Y2	Housing Nut, No. 10-24 Hex.	20
SPX1500E	Impeller (refer to part number on original equipment)	25
SPX1500F	Impeller (refer to part number on original equipment)	10
SPX1500CAP	Strainer Housing w/Basket	1
SPX0710Z3	Strainer Cover O-Ring – for solid cover (1978 and prior)	10
SPX1500D2A	Strainer Cover, w/O-Ring	10
SPX1500P	Strainer Cover O-Ring	10
SPX1250RA	Strainer Basket (1992 and prior)	10
SPX1500LX	Strainer Basket – Large, 4 1/2" x 7"	10
SPX1500RA	Check Valve Assembly (1990 and prior)	10
SPX1500W	Strainer O-Ring	10
SPX1700FG	Drain Plug w/Gasket	10
SPX1500X1	Shim for vertical discharge (1999 and prior)	10
SPX1515C	Strainer Housing C-Clip (2000-2003)	10
SPX1515CN	Strainer Housing C-Clip (2004-)	10

SP1500UN Parts same as SP1500 Series except as listed below:

SPX1500AAT	Pump Housing w/External Thread (1985 and prior)	4
SPX1501AAT	Pump Housing w/External Thread – O-Ring style	4
SPX1500B1T	Housing Cover w/External Thread (1985 and prior)	2
SPX1501BT	Housing Cover w/External Thread – O-Ring style	2
SPX1500L	Impeller, 1 H.P.	10
SPX1082Z5B	O-Ring, Pump Housing	10
SPX1500JS	Union End Connector – Socket	5
SPX1500JT	Union End Connector – Threaded	5
SPX1500G	Union Nut	10
SPX1495Z1	O-Ring, End Connector	10